

RZB - Rudolf Zimmermann, Bamberg GmbH
 Rheinstraße 16
 96052 Bamberg
 Telefon: 0951/7909-0
 Telefax: 0951/7909-198
 E-mail: info@rzb-leuchten.de



~ 220 - 240 V 50/60 Hz IP 54



3 x 1,5 mm²
2,50 mm²

Umgebungstemperatur /
temperature ambiante
=> -30 °C ... + 35 °C

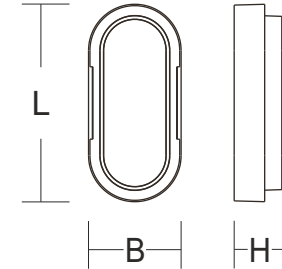

[mm]					
L 207, B 97, H 56	LED	1 x 9,5 W			
Φ_{lm}	P_{W}	EEK ₁	EEK ₂		
1100	9,5	A++	A++	220 g	
CCT [K]	CRI	RG ₀			
4000	80	RG 0			
I_{max} $I_{\text{max}}/2$ T50	B10 [St.]	B16 [St.]	C10 [St.]	C16 [St.]	
5,4 A / 160 μ s	38	60	62	102	

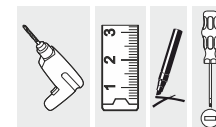

INSTRUCTION WARTUNGSPLAN/ MAINTENANCE SCHEDULE	DIN EN 61340-5-1	EN 60598 EN 1838	
EN 12464 EN 1838	INSTRUCTION WARTUNGSPLAN/ MAINTENANCE SCHEDULE	EN 12464	H ₂ O

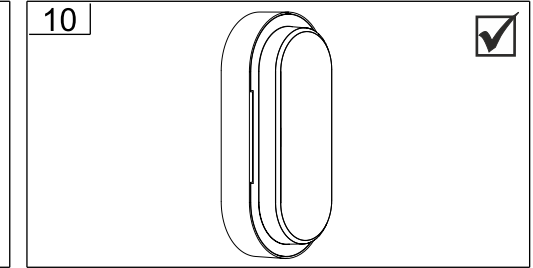
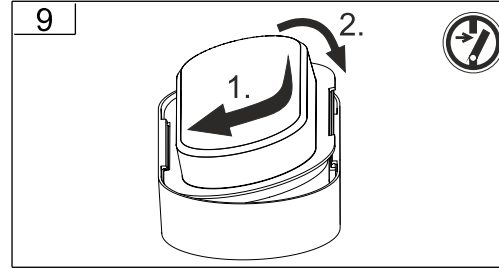
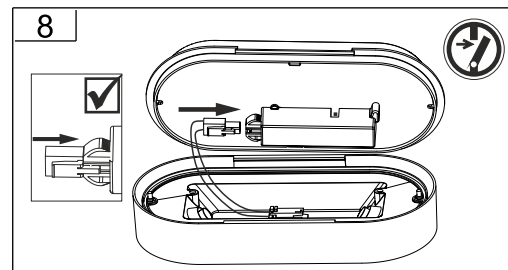
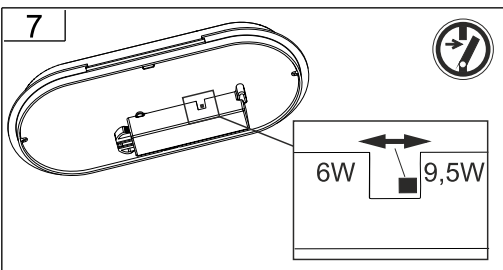
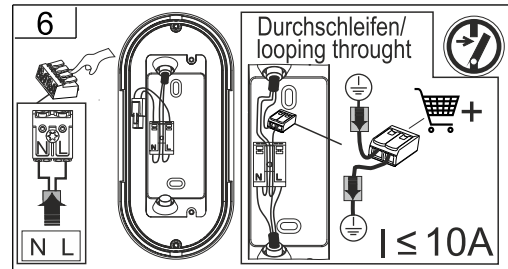
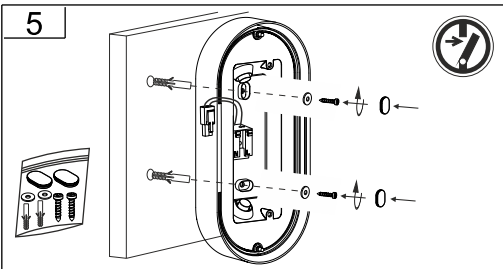
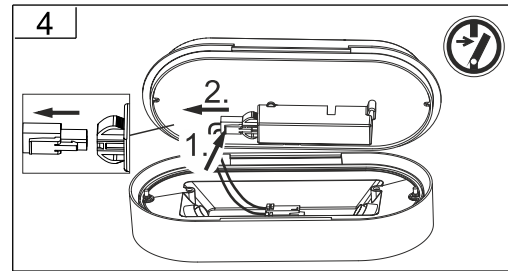
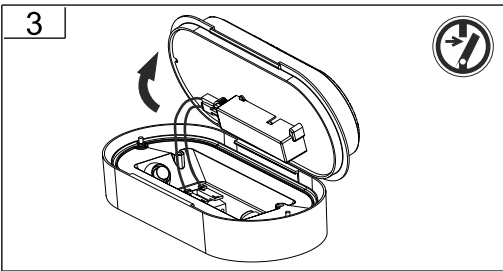
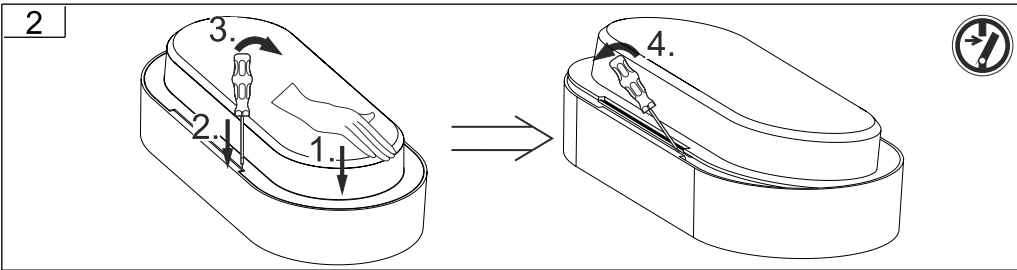
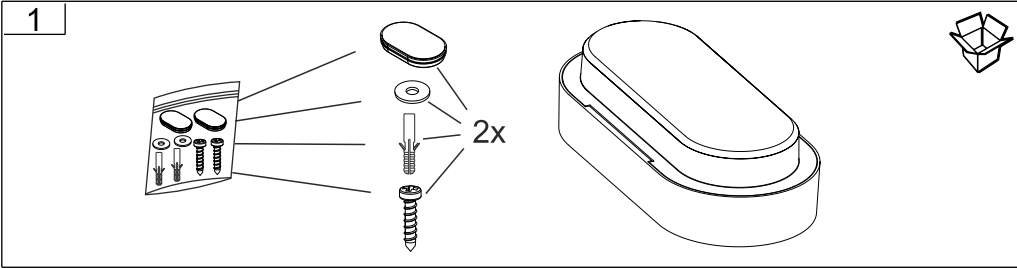
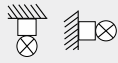

Bei Fragen zu unseren Symbolen, besuchen sie folgende Webseite:
If you have any questions about our signs, visit the following website:
www.rzb.de/fileadmin/assets/downloads/PDF/RZB_Symbolklaerung.pdf