

Presskabelschuhe DIN 46235

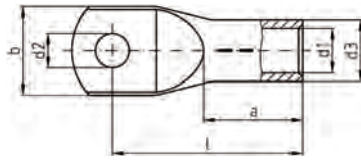

Anwendung: Für ein-, mehr-, fein- und feinstdrähtige Leiter
 Werkstoff: gem. DIN EN 13600
 Cu-HCP
 Oberfläche: galvanisch verzinkt
 wahlweise blank, Artikel-Zusatz „BK“
 Querschnitt: 6 - 1000 mm²

| Querschnitt mm ² | Bohrung | Standard verzinkt Typen-Nr. | Kennziffer | Abmessungen in mm | | | | | | Ca. Gewicht in kg je 100 St. | VE | Wahlweise blank Typen-Nr. |
|--------------------------------|---------|-----------------------------------|------------|-------------------|------|------|------|-----|-----|------------------------------------|----|---------------------------------|
| | | | | d1 | d3 | d2 | b | l | a | | | |
| 240 | 10 | ICD24010* | 28 | 21,5 | 29 | 10,5 | 42 | 92 | 40 | 27,48 | 10 | ICD24010BK* |
| | 12 | ICD24012 | | | | 13 | 42,5 | 92 | | 27,08 | 10 | ICD24012BK |
| | 14 | ICD24014* | | | | 15 | 42,5 | 92 | | 26,40 | 10 | ICD24014BK* |
| | 16 | ICD24016 | | | | 17 | 42,5 | 92 | | 27,63 | 10 | ICD24016BK |
| | 20 | ICD24020 | | | | 21 | 45 | 92 | | 27,06 | 10 | ICD24020BK |
| 300 | 10 | ICD30010* | 32 | 24,5 | 32 | 10,5 | 48,5 | 104 | 50 | 34,80 | 5 | ICD30010BK* |
| | 12 | ICD30012* | | | | 13 | 48,5 | 104 | | 33,65 | 5 | ICD30012BK* |
| | 14 | ICD30014* | | | | 15 | 48,5 | 104 | | 34,60 | 5 | ICD30014BK* |
| | 16 | ICD30016 | | | | 17 | 48,5 | 100 | | 33,72 | 5 | ICD30016BK |
| | 20 | ICD30020 | | | | 21 | 48,5 | 100 | | 34,46 | 5 | ICD30020BK |
| 400 | 10 | ICD40010* | 38 | 27,5 | 38,5 | 10,5 | 55 | 117 | 70 | 71,55 | 5 | ICD40010BK* |
| | 12 | ICD40012* | | | | 13 | 55 | 117 | | 71,70 | 5 | ICD40012BK* |
| | 14 | ICD40014* | | | | 15 | 55 | 117 | | 71,98 | 5 | ICD40014BK* |
| | 16 | ICD40016 | | | | 17 | 55 | 117 | | 70,28 | 5 | ICD40016BK |
| | 20 | ICD40020 | | | | 21 | 55 | 117 | | 70,60 | 5 | ICD40020BK |
| 500 | 12 | ICD50012* | 42 | 31 | 42 | 13 | 60 | 130 | 70 | 86,92 | 1 | ICD50012BK* |
| | 14 | ICD50014* | | | | 15 | 60 | 130 | | 89,50 | 1 | ICD50014BK* |
| | 16 | ICD50016* | | | | 17 | 60 | 130 | | 89,27 | 1 | ICD50016BK* |
| | 20 | ICD50020 | | | | 21 | 60 | 130 | | 88,14 | 1 | ICD50020BK |
| 625 | 16 | ICD62516 | 44 | 34,5 | 44 | 17 | 63 | 135 | 80 | 83,35 | 1 | ICD62516BK |
| | 20 | ICD62520 | | | | 21 | 63 | 135 | | 82,05 | 1 | ICD62520BK |
| 800 | 16 | ICD80016* | 52 | 40 | 52 | 17 | 75 | 165 | 100 | 143,00 | 1 | ICD80016BK* |
| | 20 | ICD80020 | | | | 21 | 75 | 165 | | 145,55 | 1 | ICD80020BK |
| 1000 | 20 | ICD100020 | 58 | 44 | 58 | 21 | 83 | 167 | 100 | 189,00 | 1 | ICD100020BK |



* = nicht genormt
 Werkzeugempfehlungen auf Seite 47